

The plans, ideas, arrangements, and designs indicated or represented by this drawing are owned by, and are the property of BRIAN SHINAULT AIA ARCHITECT, and in connection with this specific project, and shall not be used, in whole or in part, for any purpose for which they were not originally intended, without written permission from BRIAN SHINAULT AIA ARCHITECT.

BRIAN SHINAULT AIA ARCHITECT expressly reserves his common law copyright and all other property rights in these plans, specifications, & fees. These documents are not to be reproduced, changed, or copied in any form or manner whatsoever, nor are they to be assigned to any third party without obtaining written permission or consent of BRIAN SHINAULT AIA ARCHITECT.

BRIAN SHINAULT AIA ARCHITECT

ARIZONA 38032
CALIFORNIA C-138148
HAWAII AR 1085
NEVADA 2018
VIRGINIA 012702

976 EDGEWOOD CI
SOUTH LAKE TAHOE,
CALIFORNIA 96150
530 541-5116
530 544-1283 FAX
WWW.BISATAHOE.COM

REVISION:

NEW MULTIHOME DEVELOPMENT FOR:
SIERRA COLINA VILLAGE
LAKE VILLAGE DRIVE
STATELINE, NV
DOUGLAS COUNTY
APN # 131R23-301-001

BUILDING #'S:
11, 12

JOB No: 13
DRAWN BY: B
CHECKED BY: B
DATE PREPARED: D
SCALE: AS NOT
FILE:

DRAWING No:

3SS-1

39 of 57 Sheets

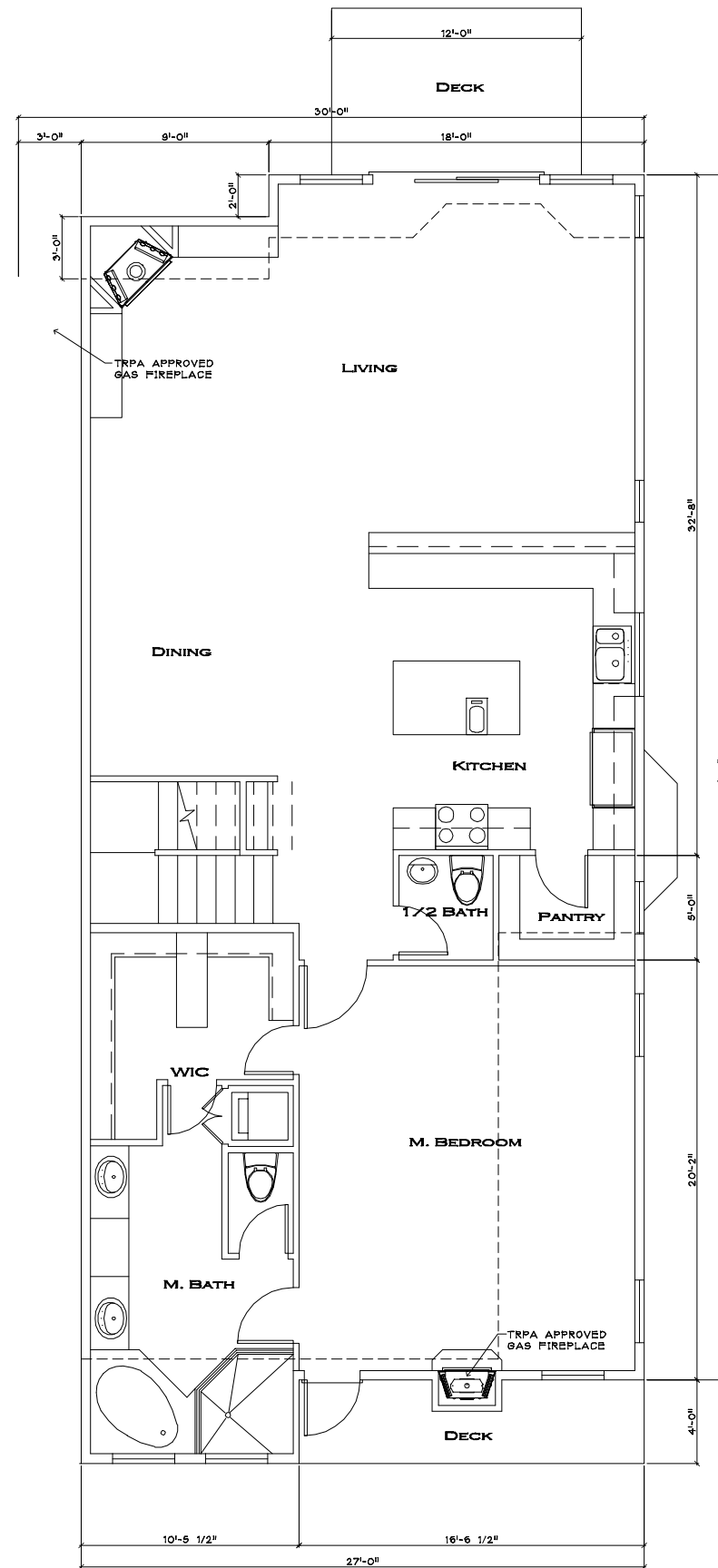

SECOND FLOOR PLAN
SCALE: 1/4" = 1'-0"

Unit Area:

First Floor:	883 sf
Second Floor:	1,606 sf
Living Total:	2,489 sf
Garage:	409 sf
Unit Total:	2,898 sf

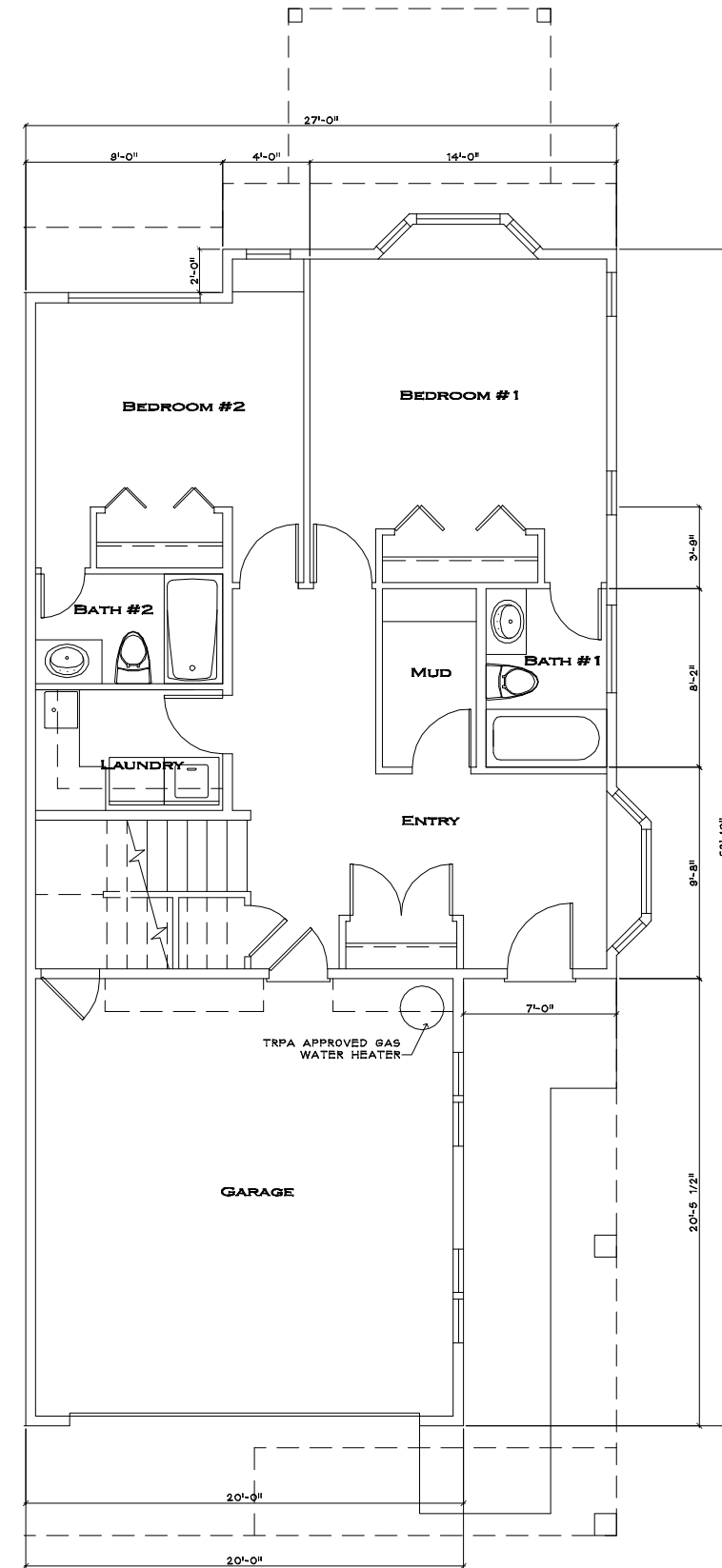

FIRST FLOOR PLAN
SCALE: 1/4" = 1'-0"

3 BEDROOM
STANDARD SINGLE(3SS)
2 BUILDINGS
2 HOMES

(REVISED) TRPA SUBMITTAL - 9/5/06
MULTI-FAMILY DWELLING FILE NO. 2006-0599
LINEAR PUBLIC FACILITY FILE NO. 2006-0598